

Rear of 18-24 Monkswell Avenue, Bolton-le-Sands

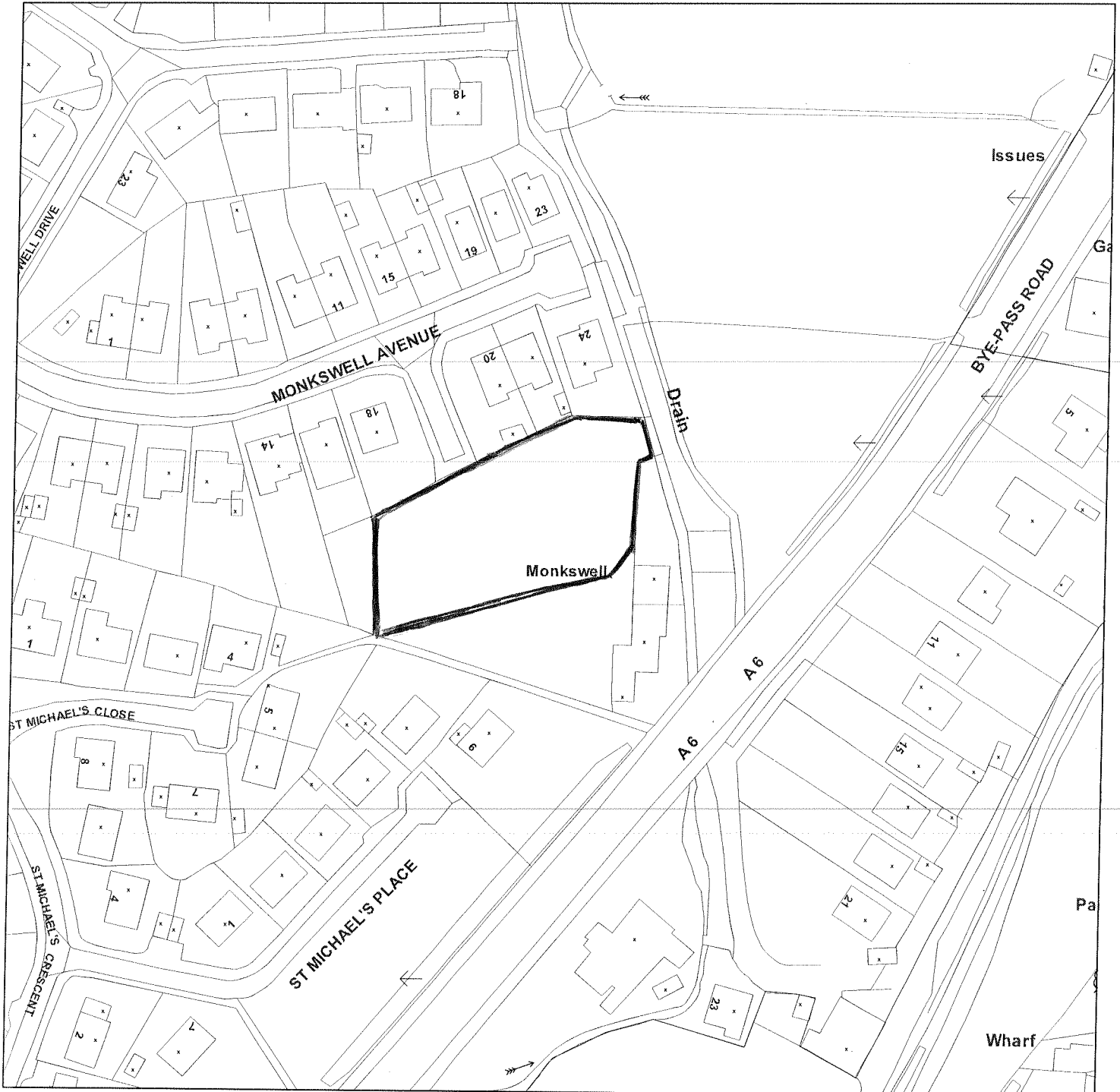

GIS by ESRI (UK)



Scale : 1:1250

Reproduced from the Ordnance Survey map with the permission of the Controller of Her Majesty's Stationery Office © Crown Copyright 2000.

Unauthorised reproduction infringes Crown Copyright and may lead to prosecution or civil proceedings.

Produced using ESRI (UK)'s MapExplorer 2.0 - <http://www.esriuk.com>

Organisation	Lancaster City Council
Department	Planning
Comments	
Date	24 May 2005
SLA Number	078379 2003